

How to set Bluetooth by Diagnostic Tool

如何使用印表機診斷工具設定藍牙設備

1. Make sure the media is already installed and media cover is closed. Turn on the printer power switch.

請確認紙張安裝正確且印字頭關閉。開啟印表機電源。

2. Open Diagnostic tool and set interface. (The default setting is USB)

開啟Diagnostic tool工具程式並設定傳輸介面(預設值為USB)

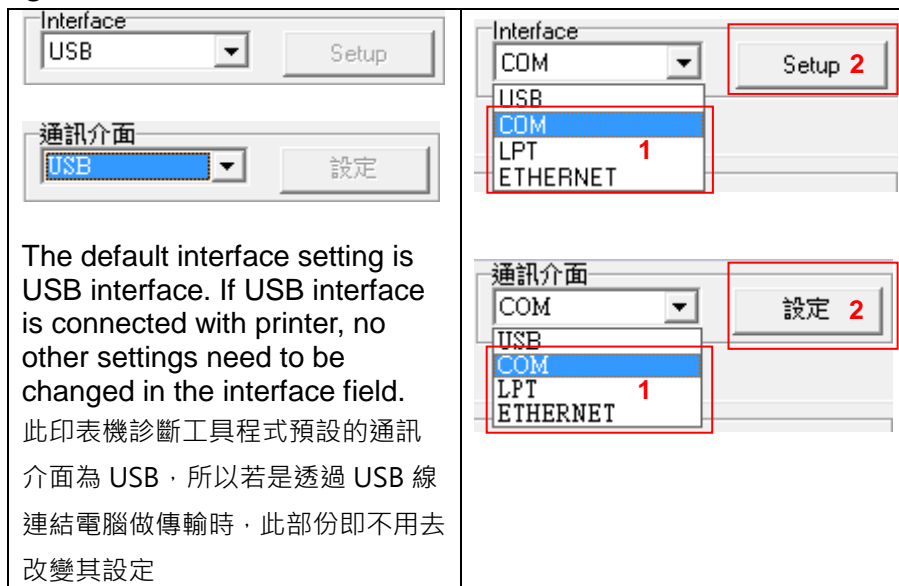

3. Select "Wireless" tab and "Built-in wireless module" item. Enter the new BT Local Name or BT PIN Code in the editor.

選取"無線"頁籤和"內建模組"以設定新藍牙名稱或藍牙PIN碼。



5. Press "Set" button to set the new BT name or BT PIN code of the printer.

按下"設定"鍵即可設定完成。

6. Press "Get" button to get back the settings. Make sure the Bluetooth module settings are set properly.

按下"讀取"鍵可讀回設定值以確定設定已完成。

Built-in wireless module

| | | | |
|----------------------|--|------------------|--------------------------------------|
| Bluetooth Local Name | <input type="text" value="RF-BHS_01"/> | WLAN SSID | <input type="text"/> |
| Bluetooth PIN Code | <input type="text" value="1234"/> | WLAN Encryption | <input type="text"/> |
| | | WLAN Key | <input type="text"/> |
| | | WLAN DHCP | <input type="text"/> |
| | | WLAN IP Address | <input type="text" value="0.0.0.0"/> |
| | | WLAN Subnet Mask | <input type="text" value="0.0.0.0"/> |
| | | WLAN Gateway | <input type="text" value="0.0.0.0"/> |

內建裝置

| | | | |
|--------|--|----------|--------------------------------------|
| 藍牙名稱 | <input type="text" value="RF-BHS_01"/> | 無線網路名稱 | <input type="text"/> |
| 藍牙PIN碼 | <input type="text" value="1234"/> | 無線加密 | <input type="text"/> |
| | | 無線加密密碼 | <input type="text"/> |
| | | 無線自動取得IP | <input type="text"/> |
| | | 無線IP位址 | <input type="text" value="0.0.0.0"/> |
| | | 無線子網路遮罩 | <input type="text" value="0.0.0.0"/> |
| | | 無線通信閘 | <input type="text" value="0.0.0.0"/> |